

Pneumatic toggle clamps

for push-pull clamping

SPECIFICATION

Type

- Type **SP3**: Body, Steel forged

Coding

- Coding **M**: Magnetic piston (for size 360 and up)

Body

Steel

- forged
- chemically blackened

Parts in sheet metal

Case-hardened Steel C10
zinc plated, blue passivated

Tapped connecting rod

Steel St 37
zinc plated, blue passivated

Bearing pins (Bearing rivets)
case-hardened

Double-action air cylinder
max. pressure 6 bar

All moving parts
lubricated with special grease

INFORMATION

The working principle of the GN 890 pneumatic toggle clamps is identical in construction and dimensions to the manual toggle clamps GN 842 (see page 1589). To ensure an extended life of the mechanical parts as well as the air cylinders the operating pressure should not exceed 6 bar.

In addition a lubrication control unit should be fitted in the air line. The sturdy mounting frame for the cylinder has been designed to avoid the trunions of the cylinder to protrude over the frame.

GN 890 pneumatic toggle clamps are also available in sizes 360 and up as a version M (magnetic piston). In conjunction with GN 896.1 (see page 1622) / GN 896.2 (see page 1622) proximity switches, the piston position can be sensed and the generated impulse can be used to transmit an electrical signal.

- General information for toggle clamps (see page 1560)

ACCESSORY

- GN 896.1 proximity switch (see page 1622)
- GN 896.2 proximity switch (see page 1622)

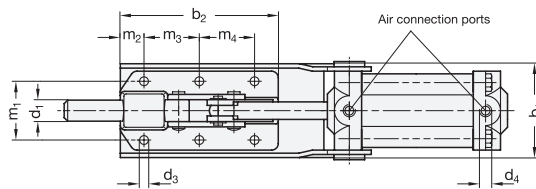
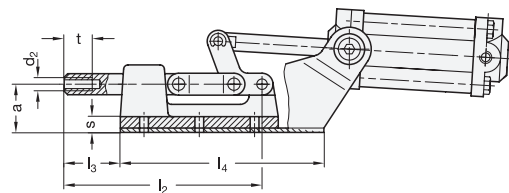
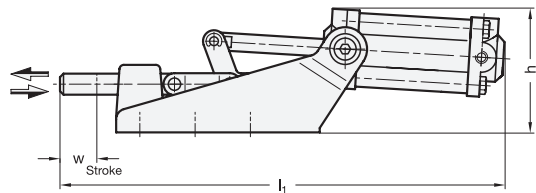

Operating principle



GN 890

Description	Size	FH	in	N	FS	in	N	a	b1	b2	d1	d2	d3	d4	Inside Ø connection tube	h	l1	l2	l3	l4	m1	m2	m3	m4	s	t	w	⚖
GN 890-70-SP3	70	1200				550	14	42	64	8.5	M6	4.3	G1/8		4	52	171	78.5	20	64	26	13	26	-	8	12	12	556
GN 890-360-SP3	360	5600				1000	27.5	55	90	12	M8	5.5	G1/8		4	70	260	113	32	116	33.5	30	36.5	-	9.5	16	21	1285
GN 890-1100-SP3	1100	16000				1850	28	66	133	16	M10	8.5	G1/4		6	88	355	171	49	167	41	15	35	41	12	18	31	2400
GN 890-2100-SP3	2100	25000				3000	38.5	80	177	20	M12	8.5	G1/4		8	100	469	222	61.5	231	50	35	50	50	13	22	45	4830
GN 890-360-SP3-M	360	5600				1000	27.5	55	90	12	M8	5.5	G1/8		4	70	260	113	32	116	33.5	30	36.5	-	9.5	16	21	1400
GN 890-1100-SP3-M	1100	16000				1850	28	66	133	16	M10	8.5	G1/4		6	88	355	171	49	167	41	15	35	41	12	18	31	2440
GN 890-2100-SP3-M	2100	25000				3000	38.5	80	177	20	M12	8.5	G1/4		8	100	469	222	61.5	231	50	35	50	50	13	22	45	4800

